

nuPro X-6000

**Wireless
Active Speakers**

**Instruction manual
Safety Instructions
Technical data**



nubert®

Device approval and conformity with EC directives

Nubert electronic GmbH hereby declares that this product complies with the 2014/53/EU directives, provided that it is installed and used in accordance with the manufacturer's instructions. The full text of the EU Declaration of Conformity is available at the following Internet address:

<https://www.nubert.de/konformitaetserklaerungen/716/>

- Do not change the serial number on the speaker. It is part of the operating approval.
- If the loudspeaker is repaired or modified by workshops or other third parties not authorized by Nubert, it loses its operating license.
- Only accessories and devices may be connected which in turn comply with all legal requirements and are approved.
- The loudspeaker may only be used for the applications specified in the „Intended Use“ section

Intended use

This speaker is designed exclusively for sound reproduction in dry rooms. Use the speaker only as described in this manual. Any other use (particularly safety-relevant or medical use, installation in open environment like IP-certified products) is considered improper and may result in property damage or even personal injury. Nubert electronic GmbH does not assume any liability for damages caused by improper use.

Safety instructions

The entire operating manual, in particular the safety instructions, must be read in full before connecting and commissioning the device. For your own safety, be sure to follow all warnings and safety instructions in this manual and on the speaker. The user is not permitted to carry out any work on the loudspeaker other than the described work. Keep this document so that you have access to it at all times. Furthermore, it must also be handed over to possible re-owners.

Key to the symbols



The triangle symbol with exclamation mark (without additional comment) indicates important instructions for commissioning, operation and maintenance of the device.

The term **Caution!** next to the triangle symbol indicates a medium risk. Failure to observe this warning may result in property damage.

The term **Danger!** next to the triangle symbol indicates a high risk. Failure to observe this warning may result in death or personal injury



This symbol indicates that you must read and observe the operating instructions and the safety and warning notices in order to operate the device.



This symbol (triangle with lightning) warns of dangerous voltages inside the enclosure and of hazards due to electric shock.



This symbol indicates that the device complies with electrical protection class 2 and therefore does not require earthing.



Devices with this symbol may only be used in a dry indoor environment.



Equipment marked with this symbol must not be disposed of with household waste. Refer to the Disposal and Battery Return section at the end of this manual.

General information



Never operate the loudspeaker unattended!



Danger of electric shock!

To avoid the risk of electric shock, the speaker may not be opened by the user. There are no user-serviceable parts inside the speaker.

Service work and repairs are reserved for qualified specialists authorized by Nubert. If you need service, please contact Nubert electronic GmbH directly (info@nubert.de)!



Danger of suffocation!

Never let children use or play with neither speaker, remote control or packaging unattended. There is a risk that children will get caught in the packaging film and suffocate. Make sure that children cannot remove any small parts from the devices! These parts, like the remote control battery, could be swallowed and cause suffocation. In case of swallowing any parts, contact a doctor immediately!



Danger of injury or damage!

When moving the speaker, take care to avoid injury and damage!



Caution!

Since the speaker can only be completely disconnected from the mains at the mains input on the rear of the unit or by pulling the mains plug from the socket, it must be positioned so that you have free access to the mains input or mains plug. If any of the following situations occurs, the loudspeaker must be switched off immediately and disconnected from the mains. Contact Nubert electronic GmbH (info@nubert.de) immediately!

- The speaker has been damaged or has fallen down.
- Power cord or plug is damaged
- Objects or liquid have got into the loudspeaker
- The speaker has been exposed to excessive moisture or rain.
- The speaker does not work properly or exhibits a significant reduction in performance.
- The loudspeaker smells burnt, develops smoke or makes unusual noises.



Only use accessories recommended by Nubert!

Installation instructions



Caution!

An unstable location can damage the speaker.

- Only place the loudspeaker on a flat, stable surface and make sure that it cannot be knocked over!
- Also make sure that no unintentional pulling can occur on the cables to avoid knocking over the speaker or damaging the connection sockets!
- Keep strong mechanical shocks away from the loudspeaker!



Caution!

Excessive heat build-up inside the unit can shorten its service life or lead to fire.

- Never cover the back of the speaker! Make sure that there is a clearance of at least 10 cm and sufficient air circulation in the back area!
- Do not operate the speaker and remote control near heat sources such as radiators or stoves!
- Do not set the speaker and remote control to direct sunlight.
- Do not expose to direct sunlight!
- Never place burning candles or similar open fire sources on the loudspeaker!



Danger of explosion!

Installation in unsuitable locations can cause explosions. Do not use the speaker or remote control

- in environments where there is a risk of fire or explosion!
- at extremely low or extremely high temperatures!
- near flammable gases or vapours!
- near strong dust!
- near flammable materials!

Danger of electric shock!

The loudspeaker carries mains voltage and voltages higher than 35 V AC or DC inside. It has no special protection against the intrusion of liquids or objects into the system. There is therefore a risk of lethal electric shock.

- Never touch the speaker with wet hands!
- Only use the speaker in a dry place!
- Do not operate it outdoors or in damp rooms!
- The loudspeaker must be protected from liquids of all kinds, including dripping and splashing water.
- Do not place any containers containing liquids (e.g. flower vases) on the speaker or in the immediate vicinity!
- If the loudspeaker is moved from a cold environment to a warm room, condensation may form inside the unit. Wait at least six hours until the loudspeaker has reached room temperature and is dry before switching it on!
- No objects or foreign bodies may get into the device.
- Should the loudspeaker come into contact with liquids or should objects have got inside, please unplug the mains plug immediately and contact Nubert electronic GmbH (info@nubert.de)!

Danger of injury or damage!

For speakers with threaded bushings on the underside:

The threaded bushings may be used for upright mounting of the loudspeaker on suitable base plates only. The threaded bushings on the underside of the loudspeaker enclosures are not designed for tensile loads and must therefore not be used as holders for hooks or similar devices in order to suspend the loudspeaker cabinet. A falling speaker may cause serious injury and damage.

Connection instructions

General connection instructions

- Disconnect the mains plug before changing any wiring on the system!
- Make sure that all connections have been made correctly and that all plugs are firmly seated in the sockets before connecting the speaker to the mains.
- Use only the intended cables or plug connections for the connections! Failure to do so may result in damage or malfunction.
- If you want to disconnect connections on the loudspeaker, always pull the plug, never the cable!
- Ensure that all plugs are firmly seated in the sockets!
- Only use cables and accessories recommended by Nubert!

Danger of electric shock!

Faulty mains supply systems or excessive mains voltage can lead to electric shocks.

- All power supply or antenna systems connected to the loudspeaker must comply with all applicable laws and regulations and be professionally installed by an approved installation company.
- Use only the appropriate power cord to connect the speaker. Do not modify the power cord or its plug.
- Make sure that the mains voltage at your location matches the requirements of the loudspeaker! The correct power supply can be found on the label on the back of the speaker. It must not be connected to other power supplies.
- Devices of Class 1 construction must be connected to the mains power socket outlet with a protective earth connection. Make sure that the installation of the protective earth is carried out correctly!
- When laying the power cables, make sure that they cannot be damaged (e.g. by heating or mechanical stress)! Pay particular attention to the areas of the connectors and distributors!

Caution!

Overvoltage in the power supply system (e.g. due to lightning) can damage or destroy the device and power supply unit.

- An overvoltage protection element can provide a certain degree of protection against excessively high voltages in the power grid.
- However, the greatest possible protection against damage can only be achieved with the complete separation from the mains supply. In case of thunderstorms or danger of lightning strikes, disconnect the mains cable from the socket and any antenna plugs from your hi-fi system!
- If the speaker is not used for a long period of time or is unattended, the power supply should be disconnected. Disconnect the mains plug from the socket!

Remote control and battery

This product comes with a remote control and a battery. The following must be observed when handling remote controls and batteries:

 If the batteries are discharged, the range of the remote control will decrease significantly. If this happens, replace the batteries immediately. Always use high-quality CR2025 lithium button cells as replacement batteries. Make sure that the polarity is correct when inserting the battery into the battery compartment!

Caution!

Improper handling can lead to material damage.

- Do not drop the remote control!
- Do not expose the remote control and battery to water or other liquids!
- Do not operate or store the remote control and battery in locations with high humidity or high or low temperature!

Danger!

Leaking or exploding batteries can pose a health hazard and cause damage to goods.

- If you do not use the device for a long time or if the batteries are depleted, remove the batteries from the remote control to prevent discharge, leakage of acid or explosions.
- Leaking batteries must be replaced immediately.
- If you find a leaking battery, do not touch the leaking material and dispose of the batteries immediately!
- Do not touch leaking batteries!
- Should your skin, eyes or mouth come into contact with the leaking material, clean the affected area immediately with water and contact a doctor!

Danger! Do not ingest battery, chemical burn hazard!

Ingestion of batteries can cause severe internal burns and death within a short time span.

- Ensure that batteries do not get into your body by any means, in particular that they cannot be swallowed!
- Keep new and used batteries away from children.
- If the battery compartment does not close securely, stop using the product and keep it away from children.
- If you think that batteries might have been swallowed or placed inside any part of the body, seek immediate medical attention!



Equipment marked with this symbol must not be disposed of with household waste. Refer to the Disposal and Battery Return section at the end of this manual.

Low temperatures and Sound

When speakers are shipped and delivered during the cold months of the year, it is imperative that they adapt to the temperature of the living area. Low temperatures have a considerable influence on the moving parts of a loudspeaker such as diaphragm, voice coil, bead and spider. The ability of these components to follow rapid oscillations or to perform large excursions is thus significantly restricted. This is not dangerous, but "frozen" speakers are far from their acoustic peak.

Hence our tip: When your new speakers arrive on a cold winter's day, just give them a few hours to acclimatise. Your Nubert speakers will thank you with the superior sound quality you have come to expect from us.

Unpacking and Scope of Delivery

Auspacken

When unpacking your speaker, do not use sharp or pointed objects to avoid possible damage to the enclosure. Please keep the packaging in a safe place in case you need to transport the speaker at a later date.

Scope of delivery

If the delivery is complete, it contains the following parts:

- 1 nuPro active loudspeaker
- 1 Cloth grille
- 2 Out-rigger feet
- 1 Mounting kit (4 bolts, 1 hex key)
- 1 Remote control with battery
- 1 Mains cable, 1.75 m
- 1 HDMI ARC adapter
- 4 Signal cables:
 - SPDIF coaxial cable, 5 m
 - Stereo jack cinch cable (3.5 mm jack cinch), 1.5 m
 - Fibre optic cable with TOS-Link plugs, 1.5 m
 - USB cable (Type A/Type B), 1.5 m



Cloth Grille

Remote control



Cloth grille

The cloth grille protects the loudspeaker drivers (for example from curious children who like to press in tweeter domes) and provides a visual contrast for those who do not like the technical appearance of loudspeaker drivers. It is carefully placed against the front of the speaker and held in place magnetically. Please make sure that the surface of the baffle is not damaged.

With the cloth grille removed, the loudspeaker sounds somewhat brighter and clearer - the choice is yours!

Setup

The nuPro X are high-quality, very neutral active stereo loudspeakers. They impress with an extremely homogeneous, precise, and "direct" sound reproduction with the finest resolution in the entire frequency spectrum. However, even "honest loudspeakers" are exposed to the manifold influences of room acoustics. In order to achieve the most natural and true-to-life reproduction possible, please observe the following general installation instructions:

- The distance to rear- and sidewalls should ideally be as big as possible, we recommend at least half a meter. Some distance to the back- and side walls also helps prevent an increase in the bass- and fundamental ranges.
- If the bass reproduction is perceived as being too strong when the speakers are placed close to a wall, you can raise the lower cut-off frequency of the speakers, as described on page 8 under *system hp*, and/or adjust the bass volume with the bass control as a "countermeasure".
- Within horizontal listening angles up to 30 degrees off the horizontal axis, you will experience no significant change or loss in sound quality. Only at wider listening angles does the sound lose its brightness slightly. It is then advisable to point the speakers towards the listening position.
- The most natural sound is achieved when the tweeters are approximately at ear level. But even 20 degrees above or below the tweeter axis, the sound is still homogeneous. If your active speakers need to be placed lower or higher, they should ideally be angled so that the tweeters are aimed at the listening position.



Mains cable, 1.75 m



HDMI ARC adapter

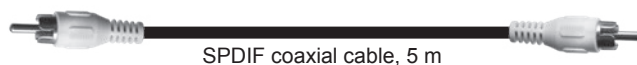

SPDIF coaxial cable, 5 m

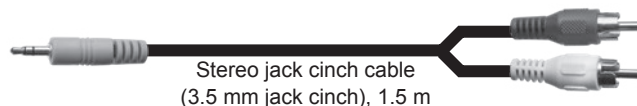

Stereo jack cinch cable
(3.5 mm jack cinch), 1.5 m



Fibre optic cable with TOS-Link plugs, 1.5 m

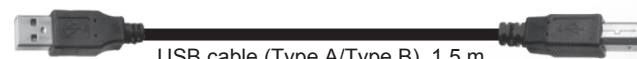

USB cable (Type A/Type B), 1.5 m

Connections and application examples

The nuPro boxes must be completely wired before switching them on, see also our separate Quick-Start instructions.

An additional active subwoofer can also be connected on request.

Using the remote control or the Nubert X-Remote App, you can select which of the connected devices you want to hear from the input sources (see page 7, section "Nubert X-Remote" App)..

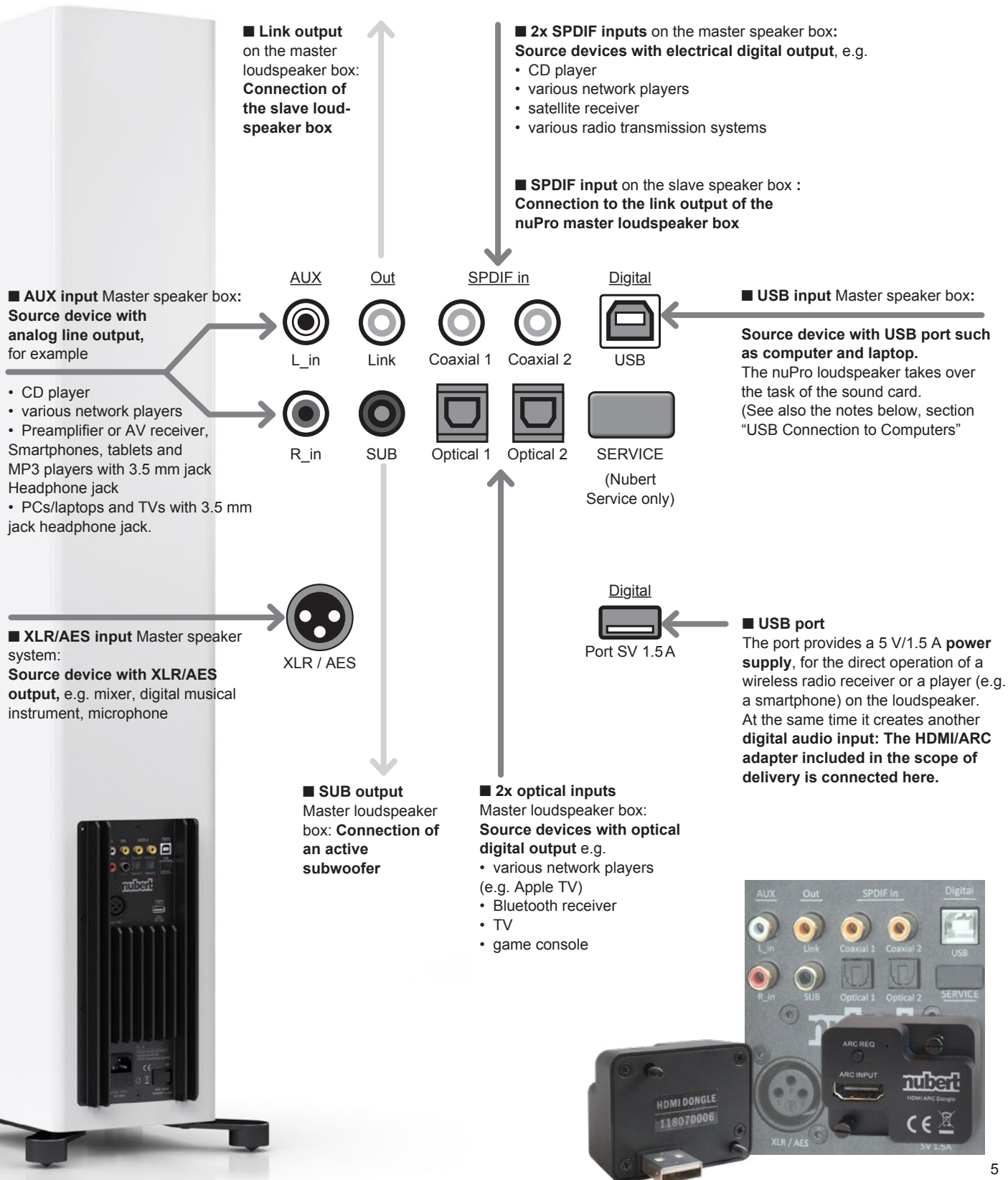

USB connection to computers

The Nubert nuPro X active loudspeakers use modern USB audio codec converters which support the plug-and-play standard to a high degree.

■ Windows

please download the latest driver from the Nubert web-site to your computer: <https://www.nubert.de/downloads/61/> Choose "Software / Driver" - there: "nuControl USB Driver". After installing the driver, proceed as follows:

1. Connect the nuPro X speaker to your computer using a suitable USB cable (included).
2. On the desktop, right-click the speaker icon in the status bar (at the bottom right of the screen), then left-click the Playback Devices entry. Alternatively, you can access the setting via the "Control Panel" and the "Sound" menu.
3. A window opens with a list of connected playback devices. The nuPro audio driver appears here as "Speaker 4-XMOS USB-Audio" (you can rename the default name of the device at any time in Windows).
4. Under "Advanced", select "24 Bit 192000 Hz Studio Quality" speaker properties for the best possible audio transmission quality.
5. Left-click on the entry of the "4-XMOS USB Audio" device again and select it with the button below "Default". Now click on "Apply" and "OK" to save the setting.

■ MAC OS X

1. Connect the nuPro speaker to your computer using the supplied USB cable.
2. Call up the system settings and click on "Sound" in the Hardware area.
3. Select "USB Audio DAC" from the list of available audio devices.

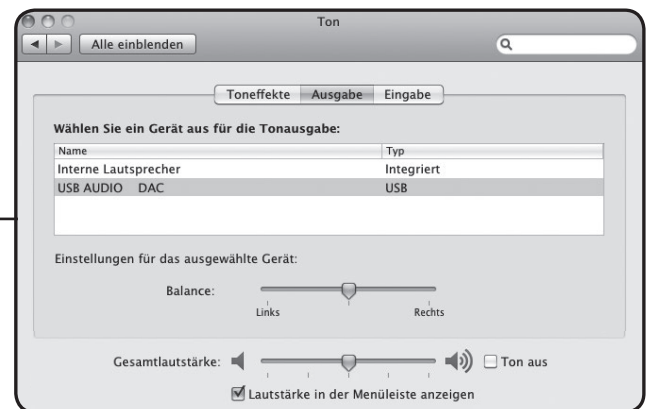
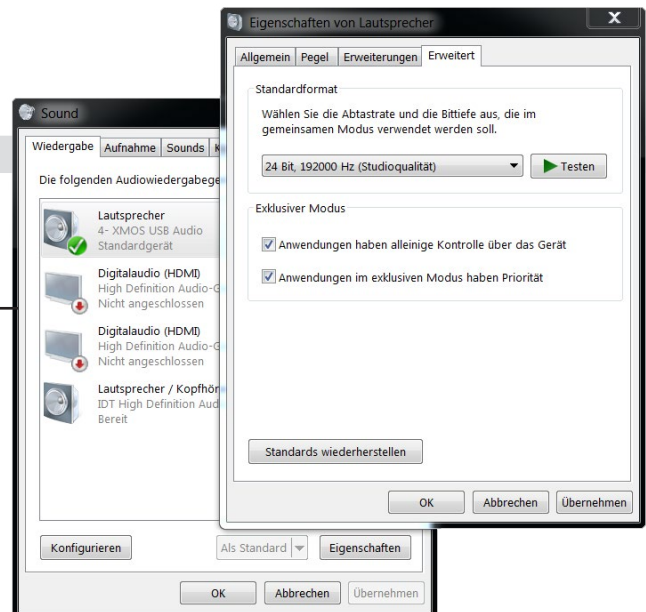

Construction and technology

Tilt Control

The midrange/treble adjustment of the nuPro loudspeakers shows the characteristics of a so-called "Tilt control". While standard treble controls "bend" the frequency response and thus produce colourations, this control continuously affects the frequency response in a linear fashion. This perfectly preserves the basic tonal character of the loudspeaker and the harmony of the sound image. The Mid/Hi tone control allows an increase or decrease of the frequency response with a maximum of 10 dB at 20 kHz.

Analog gain

The input sensitivity for the analog inputs XLR and AUX can be adjusted in 2 steps (0 dB / +6 dB).

Digital Signal Processing

For maximum signal purity, the signal path of a nuPro X is kept on the digital level as far as technically possible. Thus, the input signal is transferred to a digital signal processor (DSP) by the shortest route, which takes over the frequency distribution and the optimization of the frequency response. Also the passing on to the amplifier components is done digitally, so that the maximum signal to noise ratio and precision can be guaranteed.

Time correction

Due to the digital signal processing every nuPro X loudspeaker has a small delay of the sound signal. If the nuPro speakers are operated as a stereo pair in the PAIR configuration, any time differences between the speakers are automatically compensated so that the left and right signals are reproduced at exactly the same time. The result is the best possible spatial reproduction with precise voice positioning.

Sound format

The nuPro X loudspeakers process signals at the digital inputs in "PCM" format. It may therefore be necessary to adjust the settings of players such as TV sets or game consoles accordingly. To do this, select "PCM" as the output format in the playback menu. Please also refer to the manual of your player.

Switching off a nuPro X pair

If the master box switches to standby mode (due to automatic switch-off or manually with the remote control), the other boxes operated in PAIR mode follow automatically.

Auto-on function

The automatic switch-off/switch-on reacts differently depending on the pre-selected input. If no signal is present at the analog signal inputs, an automatic switch-off takes place within 20 minutes. Switching on is reversed as soon as a music signal is detected. At the other inputs, the activity of the connected source device is monitored and therefore immediately switched off or on. At the inputs Spdif, Optical, Port, AES the presence of the digital data stream is evaluated, while at the USB input the presence of the USB supply voltage is considered.

Note: Modern computers often have USB sockets with a voltage applied even when the computer is switched off (e.g. for charging a mobile phone). If you want to use the auto-on function of your nuPro active loudspeakers in conjunction with the USB input, you must select a USB connector that does not have continuous voltage.

Remote control

The remote control of the nuPro allows direct access to the permanently required functions:

on button

After switching *on* the mains switch, the nuPro is in stand-by or auto-on mode. Use the on key to activate or deactivate the speaker.

volume and (mute) keys

The volume can be adjusted with the *volume* keys. The mute  key allows you to mute and unmute the speakers.

bass and mid/high keys

The remote control also allows an uncomplicated adjustment of the sound character of the nuPro speakers. The *bass* keys allow the bass intensity to be raised and lowered, while the *mid/high* keys can be used to adjust the mid/high range by up to +/- 10 dB. For more information, refer to section "Scale" on page 6.

xlr, aux, coax, opto, (bluetooth) and usb buttons

The 6 buttons on the remote control below are for source selection. By pressing a key repeatedly you can switch between 2 functions (toggle):

| key | activates | toggle between |
|---|---------------------------------|----------------------------------|
| xlr | XLR/AES input | XLR ↔ AES-Eingang |
| aux | AUX Line input | --- |
| coax | SPDIF input | Coaxial 1 ↔ Coaxial 2 |
| opto | SPDIFinput | Optical 1 ↔ Optical 2 |
|  | Audio Streaming | --- |
| usb | USB-connector + Digital port | USB-connector ↔ Digital port. |



p1 · p2 · p3 keys

With these buttons you can directly recall 3 presets, which you can make and save in the setup. Alternatively, a preset can be stored by pressing and holding the respective button (see page 8)

Remote Control Signals, nuPro X-Series and nuPro Soundbars

The remote control signals of the nuPro X series and the nuPro stereo boards (remote control labeled *Remote AS*) **do not influence each other**. This means that combinations of these systems can also be operated without triggering unwanted operations.

Nubert X-Remote App



As an alternative to the remote control, you can also control the nuPro X-Series speakers with the Nubert X-Remote App, which you can download to your mobile device free of charge via the App Store or Play Store.

It offers the possibility to adjust all settings of the active loudspeakers comfortably from the listening position. All menu items can be found which are also accessible via the display.

The app is intuitive and easy to use thanks to easy-to-understand graphics.



Adjustment options:

■ **Volume:** Volume control between -100 dB.....0 dB

■ **Input:** Source selection *aux, bluetooth, xlr, aes, coax 1, coax 2, optical 1, optical 2, usb, port*

■ **Sound:** Sound settings divided into

- *mid-hi* -10 dB.....0 dB.....+10 dB
- *bass* -10dB.....0dB.....+10dB
- *balance* (left)-10dB.....0dB.....-10dB(right)
- *Loudness* on/off

■ **5-Band Equalizer** 60 Hz / 240 Hz / 1 KHz / 3.5 KHz / 16 KHz (control range +/- 6 dB)

■ Setup Pop-up:

- *single* Single operation mode
- *pair* stereo pair configuration, wired
- *wls master* Stereo pair configuration, wireless Master
- *wls slave* Stereo pair configuration, wireless Slave

■ Channel Pop-up:

- *left ch*
- *right ch*
- *mono*

■ Bluetooth, divided into:

- *pair* activates the Bluetooth pairing mode
- *reset* deletes all already paired Bluetooth devices

■ Advanced, divided into:

- *system Hp* raises the lower cut-off frequency; 1-Hertz steps - graphically supported.
- *subwoofer* sets the upper cut-off frequency for the subwoofer; 1-Hertz steps - graphically supported.
- *analog gain* 0 dB/+6 dB for analog inputs XLR and Aux.
- *preset* Memory for up to 3 individual settings.
- *display* Default settings for display and other lighting properties.
- *auto power* ON/OFF
- *default* Resets all parameters to factory settings

Configuration of the nuPro X loudspeakers

please note the „Menu sitemap and navigation“ on page 10/11

Every nuPro X has the same range of functions and the same connections. Depending on the cabling (see the “Setup” section), the nuPro active loudspeakers automatically configure themselves as master or slave loudspeaker boxes after switching on: the link-out loudspeaker box becomes master, the SPDIF-in loudspeaker box becomes slave. All settings of the loudspeakers are now based on this assignment. You are then ready to play.

Alternatively you can connect nuPro X loudspeakers wirelessly. After switching on your speakers, you use the MENU control in the setup to determine which of the speakers becomes master or slave - see below, topic “setup”.

All settings can be made at any time on the front of the master speaker box using the control pad and can be read on the display.

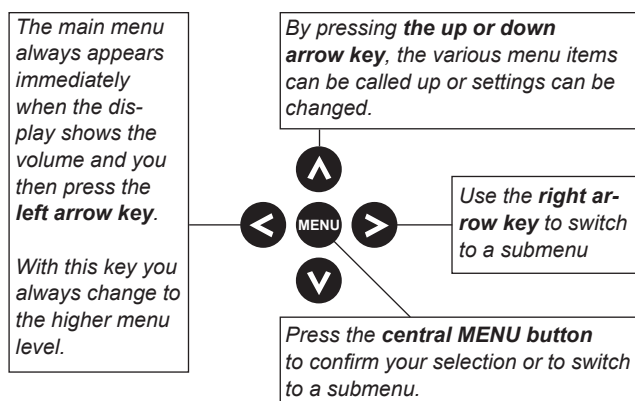

Note: If no settings are made, the display changes automatically after 8 seconds to the permanent operating display of the volume or the nuPro logo. With this change, all settings made are saved. However, if the nuPro's power connection is disconnected before the automatic saving takes place, it will load the last saved settings on restart.

■ volume

the up or down arrows to select the desired volume.

loudest setting: 0 dB

lowest setting: -100 dB

■ input

Select the desired source device with the up arrow key or down arrow key:

| | |
|--------------|---------------------------|
| AUX in | Analog Line input |
| USB in | USB input |
| Coaxial 1, 2 | Digital electrical inputs |
| Optical 1, 2 | Digital optical inputs |
| XLR | Balanced analog input |
| AES | Balanced digital input |
| Port | Digital input |
| Bluetooth | Audio Streaming input |

■ sound

– mid high

The up or down arrow button can be used to raise or lower the mid/high range by up to 10 dB. See also page 6, section “Tilt control”.

– bass

The up or down arrow key can be used to increase or decrease the bass range by up to 10 dB.

– balance

With the up or down arrow button, a volume difference of up to 10 dB can be set between the two speakers of a stereo pair.

– loudness

Use the up or down arrow key to select between loudness on/off.

– 5-band-equalizer

Press the MENU button to enter the Eq settings. Press the MENU button again to exit the area. Use the left and right arrow keys to navigate through the individual bands.

Use the up or down arrow key to raise or lower the level.

■ setup

This menu item is used to select the operating mode.

If you want to freely configure your boxes individually, you can select the menu item **single** here. You now have access to the complete configuration of the speaker box.

If you operate your nuPro active loudspeakers as a stereo pair, select **pair** for both speakers. This is also the factory setting. The boxes thus configure themselves automatically as slave and master. Both speakers can be operated from the master speaker box.

For wireless operation, select **wls slave** on the slave speaker box and **wls master** on the master speaker box and confirm your selection. The loudspeakers now connect (display: connecting) and confirm the connection (display: connected).

Stand-by power consumption increases to 1.3 watts in wireless mode.

■ channel

Here you can specify whether the respective nuPro X should play the left (LEFT) or right (RIGHT) channel. If you want the loudspeaker to reproduce a mono signal, this can also be set here. In master/slave mode, the slave speaker box automatically follows the channel selection.

■ bluetooth

Use the up and down arrows to select between **pair** and **reset**. Press MENU under **pair** to activate Bluetooth pairing. This is active for one minute and waits for an available device.

Reset resets the devices stored in the background. This is necessary if more than 8 different devices have been paired with the nuPro X via Bluetooth.

■ advanced

– system hp (high pass and cut-off frequency)

Here the lower cut-off frequency of the nuPro active loudspeakers can be adjusted. This can be especially useful when used with a subwoofer.

To change the lower cut-off frequency, select the system-hp with MENU. With the up or down arrow key the start value “10 Hz” can be changed in 1-Hertz steps.

– subwoofer

The subwoofer output only outputs low frequency sounds. The desired crossover frequency can be set under this menu item. Use the up or down arrow button to do this.

Note: The **SUB out output** always outputs a mono signal formed from the signal of the current source device.

– analog gain

The input sensitivity for the XLR and AUX analog inputs can be adjusted in two stages:

0 dB (up arrow button) and +6 dB (down arrow button)

– preset

3 presets are available for saving individual settings. A preset is saved by selecting **save as**. Use the up or down arrow keys to select the memory location **p1**, **p2**, **p3**.

Press the MENU key to confirm the memory settings for the previously selected p1, p2, p3.

– display set

This menu item contains 2 submenus: **content** and **light**.

content **volume** (up arrow key) and **logo** (down arrow key):
This function permanently sets the default display to volume or to the Nubert nuPro logo.

light **normal** · **autodim** · **auto off**:
This function sets the illuminance of the display:
normal = permanent full brightness
autodim = the display dims automatically after 8 seconds.
off = after 8 seconds automatic switching off of the display.

– auto power

The nuPro's electronics have an automatic standby function that automatically switches the loudspeaker into power-saving mode when it is not needed - and also switches it back on again automatically. If the menu item **off** is selected here, this is automatically deactivated.

Note: For more information on the stand-by automatic function, see page 6 in the Design and Engineering section.

– default

This menu item is used to restore the delivery status. Press the MENU button to confirm the reset operation. **Loading** is displayed while the settings are being made.

Note: Alternatively, the reset can be performed at any time by pressing the right arrow key for 8 seconds.

Technical Data nuPro X-6000

| | |
|---|---|
| Prinzip | Fully Active HiFi/Studio/Multimedia Loudspeaker 3-Way Bass Reflex System |
| Drivers | 1x Tweeter with 25 mm fabric dome 1x 148 mm midrange driver and 2x 148 mm bass drivers with polypropylene composite cone |
| Power of built-in amplifiers | 4x 120 Watt (rated power) 4x 200 Watt (music power) |
| Frequency response | 28 – 22 000 Hz +/- 3 dB 30 – 22 000 Hz +/- 2 dB |
| Input sensitivity | 1 V for analog gain +6 dB 2 V for analog gain +0 dB |
| Max. Input | 4.5 V _{rms} |
| Standby power consumption | 0.7 Watt (single / pair) 1.3 Watt (wls master / wls slave) |
| Maximum sampling rates at all digital connections | 24 bit / 192 kHz |
| Radio frequency bands and 2402 – 2480 MHz | radio transmitting power 15.8 dBm / 37.6 mW |
| 5180 – 5240 MHz | 9 dBm / 8 mW |
| 5736 – 5818 MHz | 9 dBm / 8 mW |
| Hight | 110.5 cm total incl. out-rigger feet |
| Width of housing | 18.5 cm |
| Depth of housing | 23 cm incl. amplifier |
| Weight | 19 kg |

Further Applications

Conjunction with a subwoofer

If your nuPro active speakers are to be used in conjunction with a subwoofer, you can connect it to the **SUB** connector. This provides a mono sum signal with a low pass filter for subwoofers. The cross-over frequency can be selected in the **sub out** menu item. The selection of the suitable crossover frequency of the nuPro active loudspeakers can be made under **system hp** (see above "Configuration > advanced > system hp"). The relative volume of the subwoofer can be adjusted at the subwoofer itself.

Connecting a nuPro pair to a preamplifier

In addition to connecting a preamplifier to a nuPro pair in master-slave mode, an external preamplifier can also be connected directly to the individual nuPro active loudspeakers. As with conventional active loudspeakers without master-slave functionality, the boxes can then be configured independently of each other. Connect the output of the left channel of your preamplifier to the nuPro on the left and the output of the right channel to the nuPro on the right.

Note: Assign the left input AUX L in the nuPro speaker box. Do not connect the boxes to each other with the SPDIF coaxial cable.

Use of a single nuPro

Every nuPro X has the possibility to play the left or right channel as well as a mono sum signal. To do this, select the menu item **channel**. (See above "Configuration > channel").

Use of more than two nuPro active loudspeakers

(see illustration below)

To supply a larger number of nuPro active loudspeakers with the same signal, the connection from **Link out** to **SPDIF in** can be performed repeatedly. In this case it is recommended to configure each nuPro individually and therefore to select the entry **single** in the menu item **setup**. Then you can navigate to the menu item **channel** and select the channel that the respective nuPro should play back. (For further information see section "Configuration > set-up" above).

Note: In the **single** configuration, the speaker box at the **link** output outputs the selected input signal completely in SPDIF format. It is therefore possible to transmit the signal repeatedly.

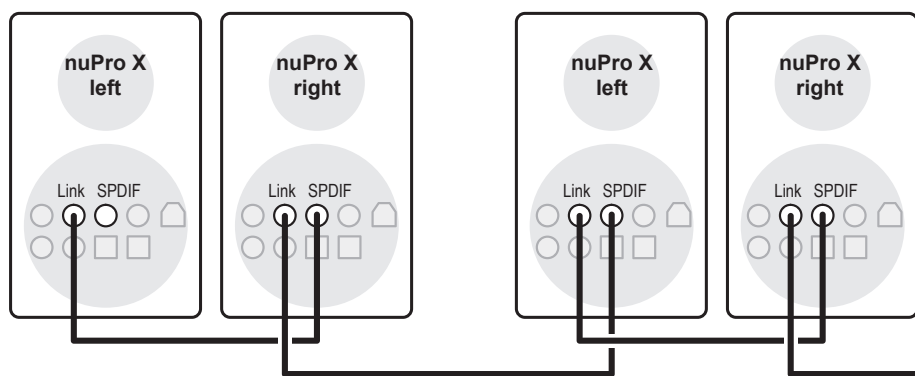

Use of more than two nuPro active loudspeakers

After switching on the nuPro X, the Nubert logo appears on the display.
After 8 seconds, the display changes to the "volume" menu.

You access menu navigation by pressing the  button.

On this sitemap, the  symbolizes the menu button.

To ease recognition, the arrow keys relevant for navigation or changes are shown in black and remaining keys are greyed out.

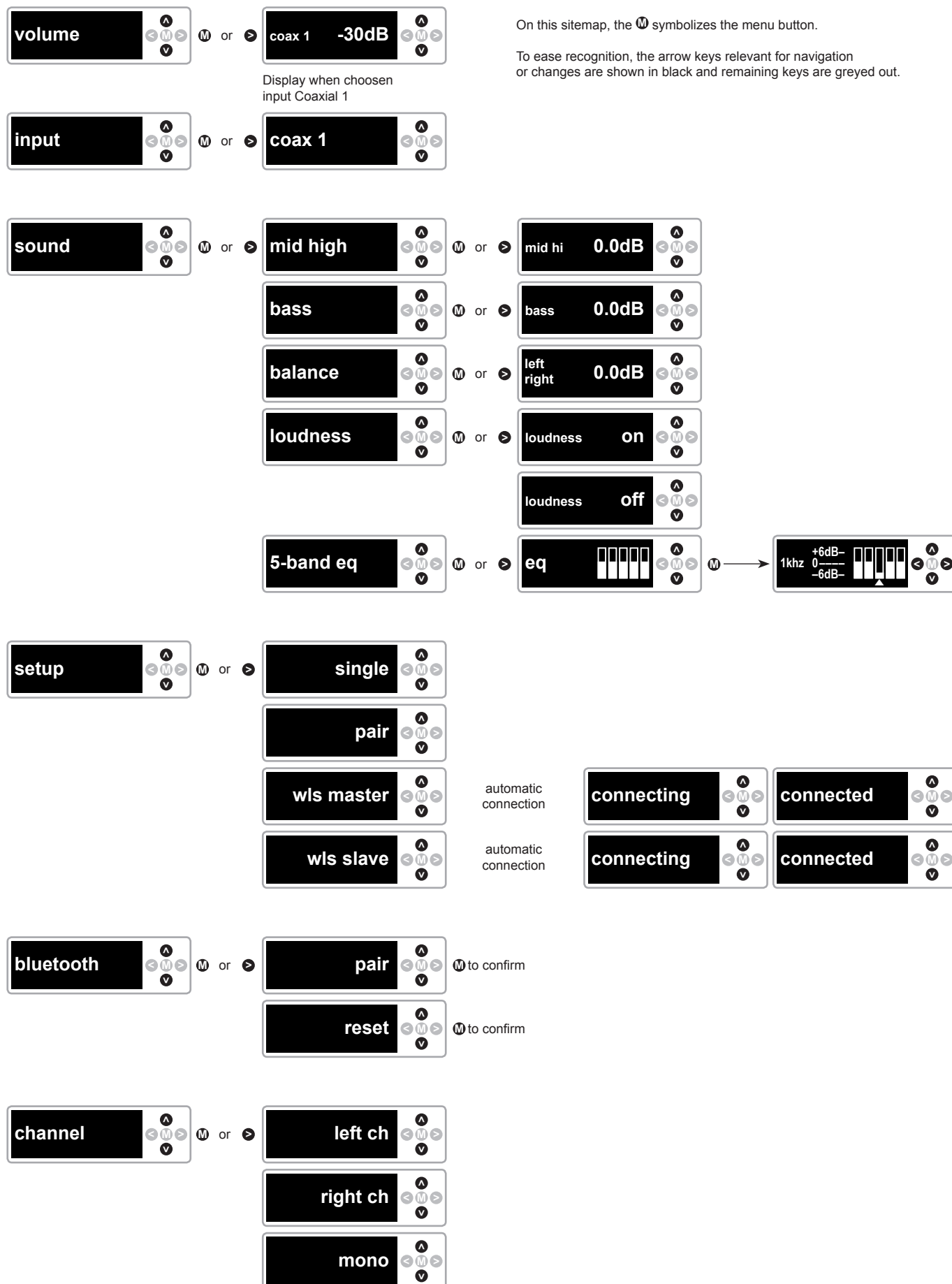

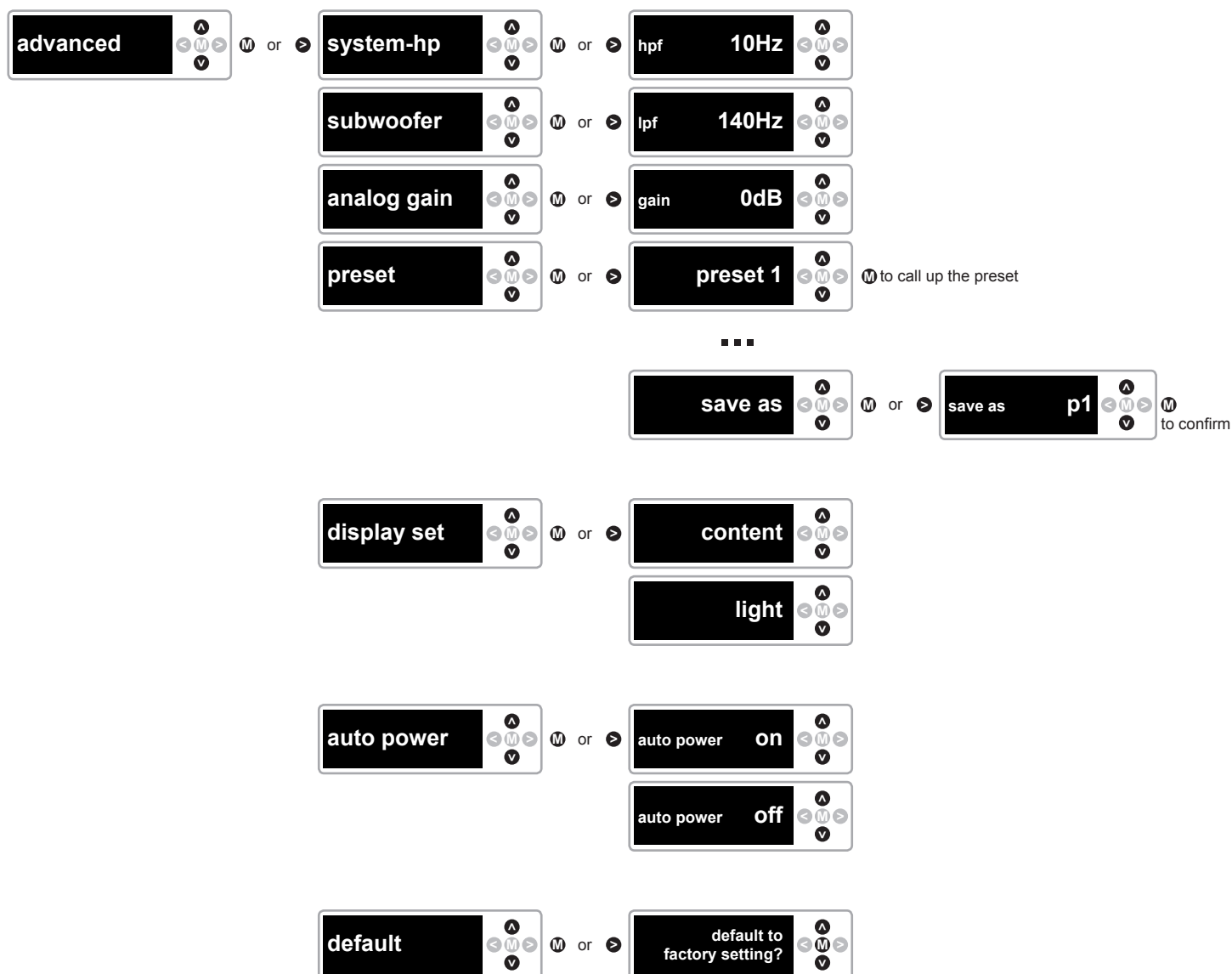

Care and cleaning tips



Caution!

Improper handling of the speaker may result in damage.

- Always unplug the speaker before cleaning it!
- Before recommissioning, make sure that all connections are correct, that there are no short circuits and that the speaker is completely dry.
- Never use strong cleaning agents or solvents such as petrol, spirit or similar!

Enclosure

We recommend commercial window cleaner sprayed onto a cotton cloth. This allows almost all fingerprints and dust to be easily removed. Alternatively, you can also use window active foam.

We advise against the use of microfibre cloths! These can cause mini scratches in the surface.

Diaphragms and Speaker Chassis

To remove dust from a loudspeaker chassis, a lint-free cotton cloth is sufficient to wipe the membrane lightly with very little pressure.

The tweeters of all Nubert loudspeakers are equipped with a protective grille so that they can also be wiped off with low pressure. If the dust cannot be completely removed, a make-up brush from the drugstore is suitable.

Service

If you have any questions or problems during the commissioning of your Nubert system, please do not hesitate to contact our service team:

Phone:

0800 68 23 780 (toll-free, within Germany)

0049 7171 92690-118 (international)

E-mail:

info@nubert.de

Please have your customer number ready!

Warranty terms

Your provider and contractual partner:

Nubert electronic GmbH, Goethestr. 69, 73525 Schwäbisch Gmünd,
Germany (German)
Phone: +49 7171 92690-0 · Fax: +49 7171 92690-145 · E-Mail: info@nubert.de
Managing Director: Günther Nubert · Register court AG Ulm, HRB 700296
Tax ID No.: DE 16758584 · WEEE Reg. No. DE 48888173

For questions and individual advice, please dial our special numbers:

- Calls from Germany - Toll Free 0800-6823780
- Calls from abroad +49 7171 92690-118

Our hotline is available from
Monday to Friday from 10:00-18:00 and Saturdays from

Nubert warrants the Nubert product described in this manual to the purchaser under the following terms and conditions.

The purchaser's statutory warranty claims, in particular for subsequent performance and, if applicable, damages in the event of defects, shall remain available to the purchaser and shall be fully available to our customers.

1. The warranty period for the Nubert product and its electronic components described in this manual is 2 years from the date of delivery

Your proof of purchase is the proof of guarantee.

2. Contents of the warranty claim

The guarantee applies to all parts and labour costs from delivery. It includes and is limited to the free repair or replacement of the defective part defect in the goods (e.g. Material defect or manufacturing defect). In addition, Nubert shall bear the costs of the return shipment of the affected part in the case of justified warranty claims, provided that the goods are within the countries of the European Union and the shipment was previously possible as a gesture of goodwill in accordance with Nubert's free discretion. For the duration of the guarantee, it is assumed that the defective part was already present at the time of transfer of risk. Replaced parts become the property of Nubert. Warranty services do not extend the warranty new warranty period in motion. The warranty period for installed spare parts ends with the warranty period for the entire device. The promise or its services is made without recognition of a performance obligation according to statutory warranty law.

3. The warranty claim does not apply in the case of

- repair attempts of any kind not previously agreed upon with Nubert
- improper operating environment or improper storage (e.g. Damage due to moisture)
- improper transport packaging (the original transport packaging, correctly used, provides sufficient protection)
- improper transport, if the transport was not previously agreed upon with Nubert (Nubert organizes the transport for you with Nubert selected transport company. You will receive return tickets with the corresponding postage paid returns).
- improper mechanical effects on the goods (e.g. on housing, switches, connection sockets or antennas)
- improper operation, improper mounting (e.g. switches, antennas) or improper connection (e.g. operation on defective or unsuitable amplifier with DC voltage or unusually high hum voltage at the source device output).

4. Disassembled components

Do not disassemble any components from our equipment and do not send in any such individual parts until you have contacted Nubert Service and

5. What to do in the event of a warranty claim

If possible, pack the defective device in its original carton with a copy of the purchase receipt and a meaningful description of the defect. Please return it. Please contact the Nubert team for a return or refund:

• Telephone within Germany 0800-68 23 780 (toll free) • Phone international: +49 7171 92690-118 • Fax: +49 7171 92690-145 • E-mail:

Of course, you can also return your defective product to the Nubert Service in Schwäbisch Gmünd or Aalen:

• Nubert electronic GmbH, Goethestr. 69, D-73525 Schwäbisch Gmünd, Germany • Nubert electronic GmbH, Bahnhofstr. 111, D-73430 Aalen, Germany

Shipping information: We recommend that you always keep the original carton, along with the protective foam inserts. Tip: Folding saves space and ensures a safe return shipment in the worst-case scenario. If, in exceptional cases, you use a different packaging, it should protect professionally against shipping and have special protective cushions or equivalent protective devices. We would like to draw your attention to the fact that we accept no liability for damage caused by improper packaging for which you are responsible!

Disposal and battery return

Environmental protection: Ingredients, e.g. chemical pollutants in old appliances, can damage the environment and health if stored improperly or not shatterproof or disposed of properly by persons not authorised to do so. Especially in the case of illegal exports, there is no guarantee that the health will be protected from damage. Old appliances can also contain recyclable raw materials, old appliances can be repaired or parts can be recycled to protect the environment. Old appliances must therefore not be disposed of with normal household waste or exported illegally. As an end user, return or properly dispose of electrical equipment. Please note: You are responsible for the deletion of personal data on the waste equipment to be returned.

Batteries:

Ingredients, e.g. chemical type of batteries, can damage the environment and health if not stored and disposed of properly. At the same time, recycling of batteries must also be included. Batteries must therefore not be disposed of with normal household waste. As an end user, you are legally obliged to return used batteries after use to the seller or in the designated collection points (e.g. in public collection points in your municipality or in the trade) free of charge. You can also send the batteries back to the seller free of charge by post, whereby any requirements of the dangerous goods law must be observed at points of sale is limited to the quantities customary for end users for disposal as well as used batteries which the distributor carries or has carried.

• Battery return

The symbol with the crossed-out dustbin reminds you not to put batteries in the household waste.

Under this symbol you can also find the following symbols with the following meaning about ingredients:

Pb = battery contains more than 0.004 mass percent lead, Cd = battery contains more than 0.002 mass percent cadmium,

Hg = battery contains more than 0.0005 mass percent mercury.

• Old appliances

Electrical and electronic equipment is also marked with the crossed-out wheellie bin symbol. The symbol indicates that you, as the owner of this appliance, may not dispose of it with your household waste (grey bin, yellow bin, organic waste bin, paper or glass).

You can send the device to the municipal collection points to be collected separately from unsorted municipal waste for reuse. Used batteries and not enclosed by the waste equipment shall be separated from it at a collection point prior to delivery. You can also return old electrical appliances. We will provide you with a return label free of charge at info@nubert.de for this purpose.

You can also request this by calling +49 7171-92690118. Please then send the old device to the following address:

Nubert electronic GmbH, Goethestr. 69, D-73525 Schwäbisch Gmünd, Germany. Please ensure that the old appliance is properly packaged for shipping and avoid as far as possible any mechanical compaction or breakage.

The acceptance of waste equipment may be refused if there is a risk to human health and safety due to contamination

As of: 20.1.2017

Technical changes, errors and misprints excepted - You will find our General Terms and Conditions (AGB) on our website: www.nubert.de/agb.htm



Nubert electronic GmbH
Goethestr. 69
73525 Schwäbisch Gmünd
Germany

E-mail: info@nubert.de
Hotline service:
• Calls from Germany - Toll Free 0800-6823780
• Calls from abroad +49 7171 92690-118